

# Spécifications joints et bagues

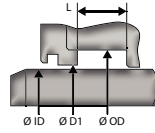

Flasher ce code  
et accédez  
au formulaire  
en ligne

## Joint de tige

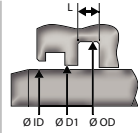
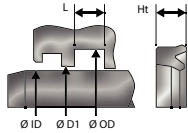

### Profils asymétriques



### Profils symétriques



### Nombre d'éléments

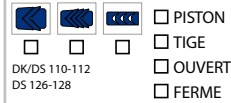

## Joint de piston

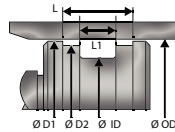
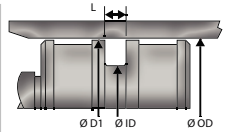
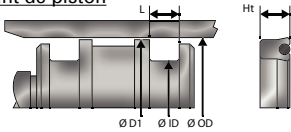

### Profils asymétriques



### Profils symétriques



## Joint racleurs

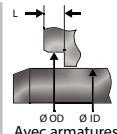
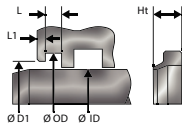

## Bague de guidage - pistons / tiges

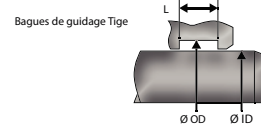
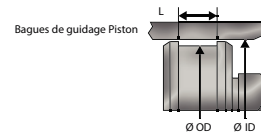
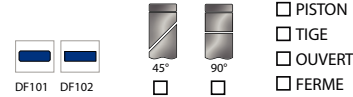

## Joints tournants

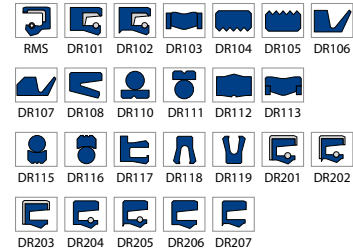

## Joints plats



## Bagues anti extrusion



## ENVIRONNEMENT

Pression	
Température	
Surface	
Fluide	
Rugosité	
Course	
Application	
Vitesse	
Délais souhaité	

## CARACTÉRISTIQUES

Ø ID	
Ø OD	
Ø D1	
Ø D2	
L	
L1	
Ht	
Profil	
N° article	
Matériau	
Quantité	

## VOS INFORMATIONS

Société*	
Nom*	
Prénom	
Téléphone*	
Email*	
Dossier	
N° de compte	

**FREUDENBERG XPRESS**  
INNOVATING TOGETHER

**MICHAUD CHAILLY**